

## Set Up - Tippy Tap Kit

The tippy tap is a hands free way to wash your hands that is especially appropriate in emergencies when there is no running water. It is operated by a foot lever and thus reduces the chance for bacteria transmission as the user touches only the soap. It uses only 40 milliliters of water to wash your hands versus 500 milliliters using a mug. Additionally, the used "waste" water can go to plants or back into the water table.

Folks die from diarrhea and acute respiratory infection that can easily be prevented by washing.

You can place a rod across a fence corner, through ladder rungs, or on stands as shown on the diagram below. Your Kit has the holes already in the containers and is ready to assemble. It is helpful to have a basin or gravel where the water falls to prevent mud and mess.

Dry hands with paper towels, or if none available, air dry. Cloth towels can spread germs. Yes, it's a bit campy, but the problems it solves are well worth it!

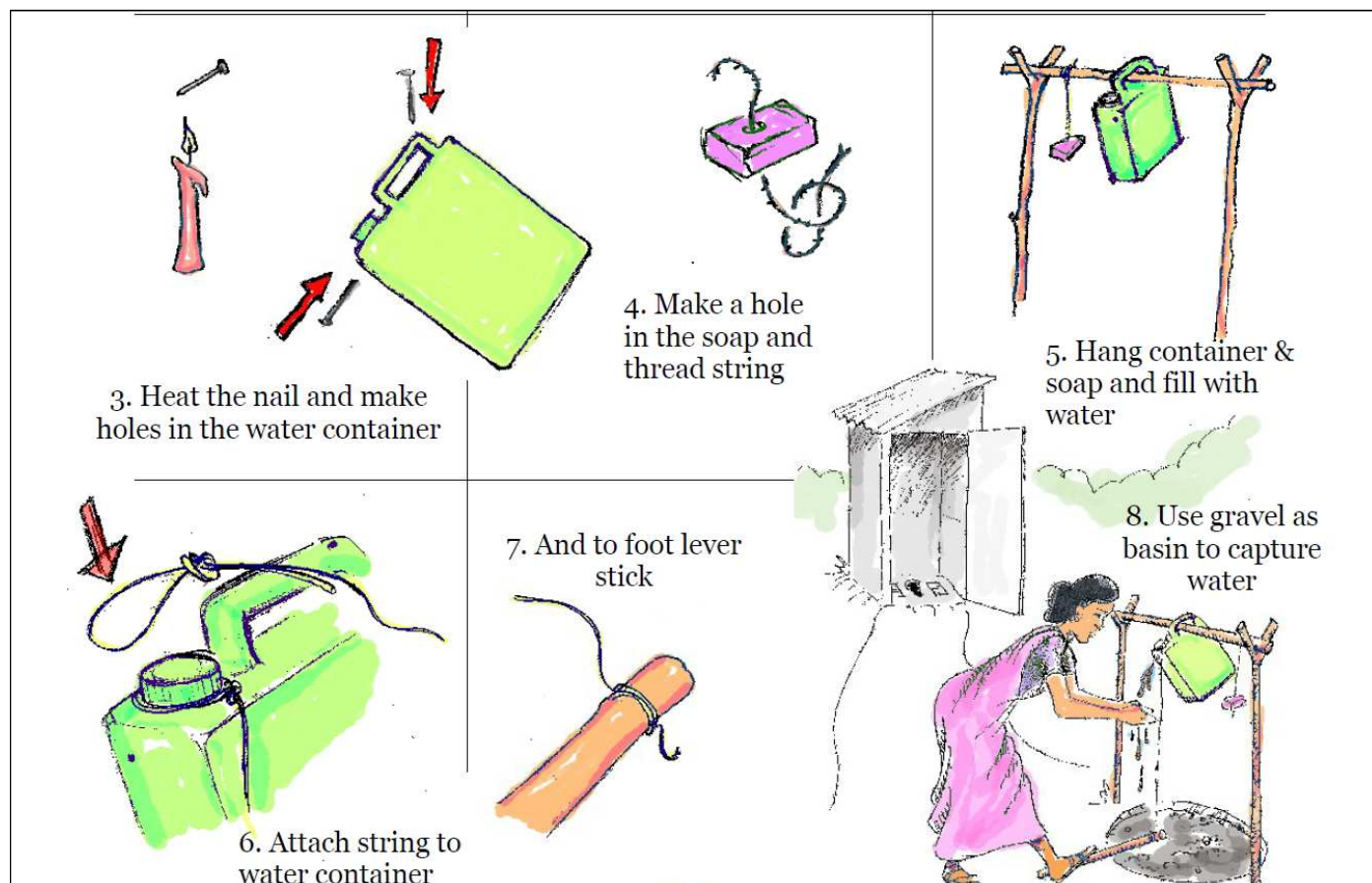

## **After Quake: Set Up and Distributions:**

Hi Folks,

Hope the following makes things easier in a bad situation. Remember that working together will put smiles back on faces. There are laminated copies of specific directions for the three Kit set ups in the barrel. But here are some early steps that make save homes and give you extra healthy returns:

**Step 1**– If sewer lines are damaged, give each family one “Clean Waste” kit which should serve them a few days until the Twin Bucket Toilets are set up and ready. The Twin Bucket system is compostable. The Clean Waste Kits are not and should be kept away from contaminating soil and saved for later disposal at a waste site provided by the City.

**Step 2**– Notify all that if uphill homes still have flushing toilets, ask them not to use until downhill homes are saying all is OK. If downhill homes become threatened with sewage flooding due to broken lines, quickly plug sewage entrance areas. Best is hydro cement if available.

**Step 3**– If there is no city water, read the enclosed instructions and set up Tippy Tap kit for hand washing. Use only clean water. Protect paper products from moisture.

**Step 4**– Local streams may become contaminated with chemicals from industry upstream. Use your one time test kit to assure water safety. Best if the barrel hosts coordinate this with other hosts so there are some kits to use later.

**Step 5**– Set up water filtration kits. There are two kits with predrilled holes for filter and faucet and air ventilation. These should provide enough clean water that each family in your Section has a gallon per day.

**Step 6**- Work together to create a manageable plan for shelter, heat and food using the Map Your Neighborhood system. Once you are comfortable, reach out to help others.